

# How to Access the Heater Blower Motor



## Instructions

**Step 1** Mark the leg base by tracing it as a reference for re-installation on the passenger side. (The paint pen shown in the image is used just as an example to demonstrate tracing the leg base.)

**Step 2** Remove the front leg upper and lower passenger side bolts.

**Step 3** Loosen the front leg upper and lower drivers side bolts.

**Step 4** Swing the leg base towards the driver's seat. You now will have access to the heater blower motor.

**Step 5** After the heater blower motor unit has been serviced, swing the leg base back to the markings, referenced in step 1.

**Step 6** Re-attach the upper and lower passenger side bolts. (Making sure the tether is attached to the upper bolt.)

**Step 7** Firmly secure all 4 bolts.

**Step 8** Check the actuation of the mail tray assembly to ensure a smooth motion when the release handle is activated. If the mail tray binds, loosen the bolts and adjust.

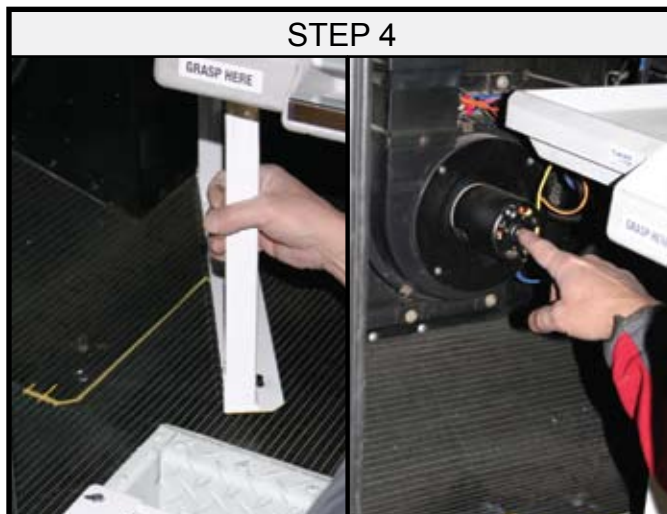

If you have any questions or concerns, please call our office at 1-800-229-4500, or visit us online at [www.postalproducts.com/stowage](http://www.postalproducts.com/stowage). These instructions will be available on our web site, as well as a demonstration video.